

Toleranzblatt

Tolerance sheet

Folio de tolerance

4

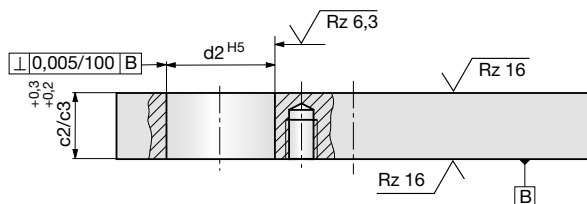
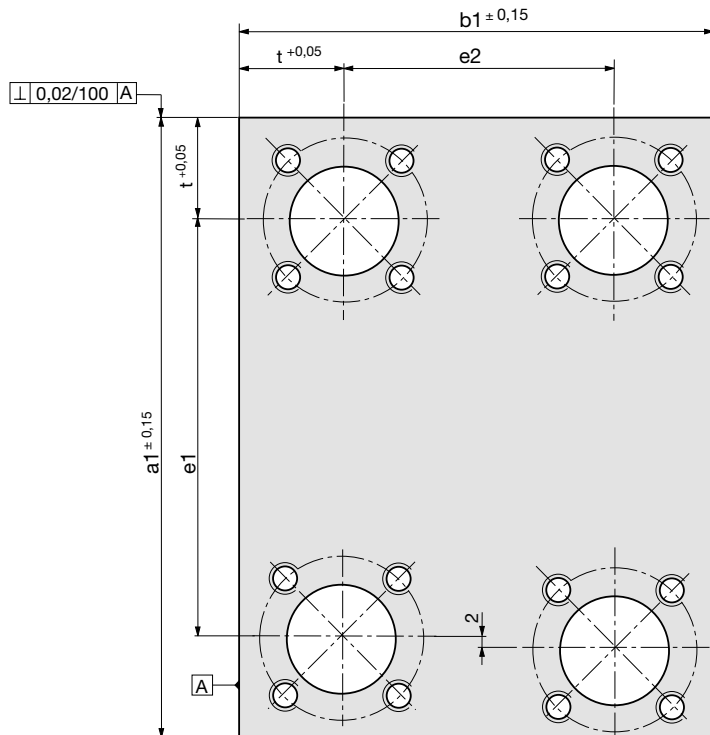

$$\sqrt{Rz\ 25} \left(\sqrt{Rz\ 16} \sqrt{Rz\ 6,3} \right)$$

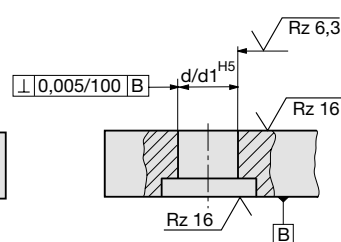
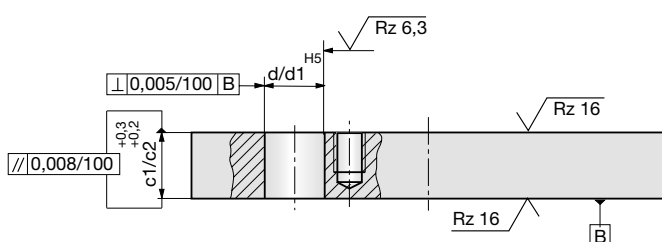
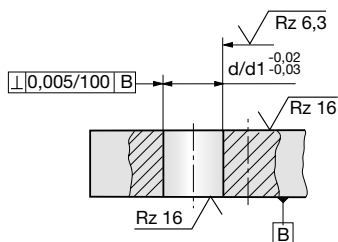

a1 / b1	Standard	Standard	Koordinatenschleifen / Jig grinding Rectification en coordonnées
	e1 / e2 St	e1 / e2 Al	e1 / e2 ST
< 200	± 0,012	± 0,015	± 0,005
≥ 200 - 500	± 0,015	± 0,02	± 0,005
≥ 500 - 700	± 0,017	± 0,02	± 0,005
≥ 700 - 1000	± 0,019	± 0,025	± 0,005
≥ 1000 - 1300	± 0,02	± 0,025	± 0,005
≥ 1300 - 3000	± 0,02	± 0,025	± 0,005

D 3001 04.2018